

STADIUM, TURIN, ITALY

RAFFAELLO FAGNONI, Architect

Most of the buildings built during the fascist regime were chiefly notable for their ideological symbolism and pomposity. Here and there among them, however, the architect managed to produce progressive work in spite of the outrageous sponsorship behind it. We believe the Turin Stadium is one such exception. On at least three counts, this huge arena makes useful contributions to design progress: as a good working solution to the common problem of accommodating crowds who come to witness outdoor sports events, in the skillful use of reinforced concrete, and in final design concept.

THE EDITORS



THE ELLIPTICAL BOWL completely surrounds the field. Twenty main entrances feed into a mid-level aisle on the field side and thus, via stairs, either up or down to the tiers of seats.

STADIUM. TURIN. ITALY

RAFFAELLO FAGNONI, Architect

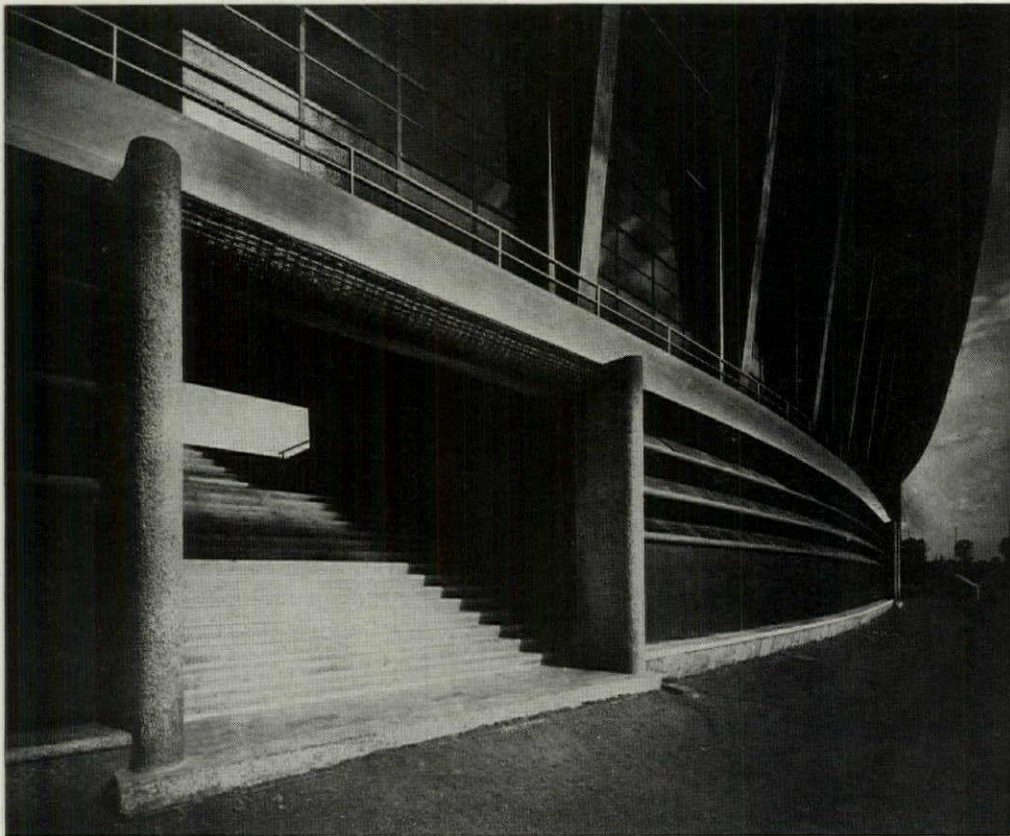

ONE OF THE 20 ENTRANCES leading into the stadium.



VIEW FROM UNDER THE CANTILEVERED CANOPY of the grandstand. In addition to a football field, the grounds include a six-track course for track events; two long-jumping units; four areas for high jumping and pole vaulting. The stadium seats 45,000 persons.

THE GROUND FLOOR, opening out to the field level directly, includes dressing and locker rooms. At the second level (underneath the lower portion of the seating) are various large rooms for reunions, exhibitions, office space, etc.

Pairs of columns occur beneath the outer edge of the great cantilevered roof, which is flush with the soffits of exposed concrete girders. Underneath the canopy is seating for 5,000 spectators.



STADIUM, TURIN, ITALY

RAFFAELLO FAGNONI, Architect

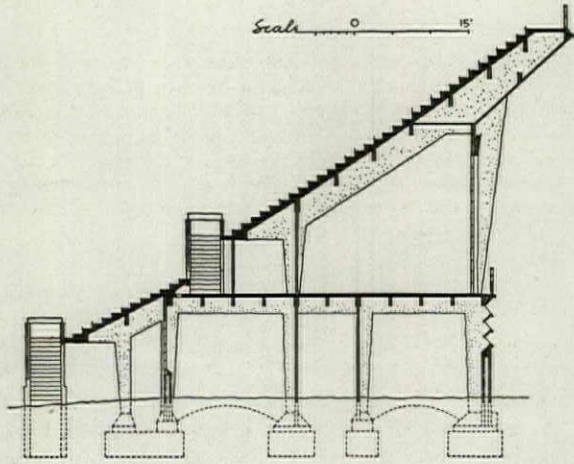

TYPICAL SECTION through bleachers, showing slope of seating and location of horizontal traffic aisle leading to both upper and lower stands.

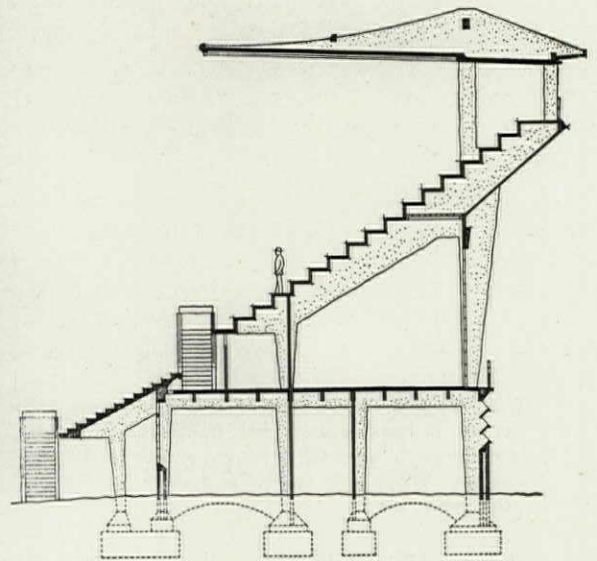
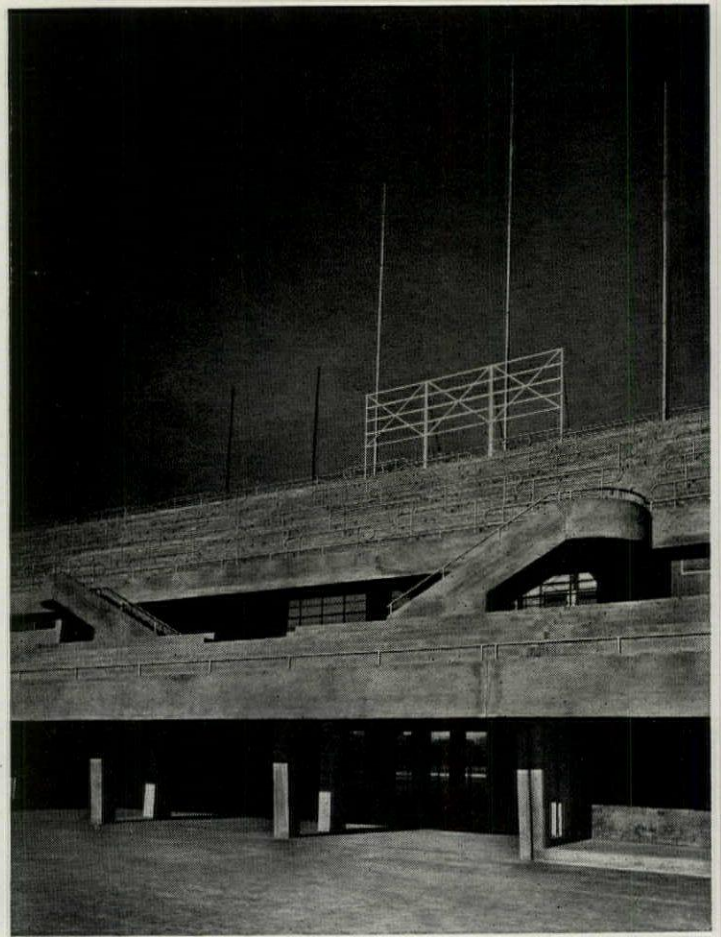

SECTION THROUGH GRANDSTAND AREA